

# RunCam2-AS

## User Manual

### Instruction Diagram

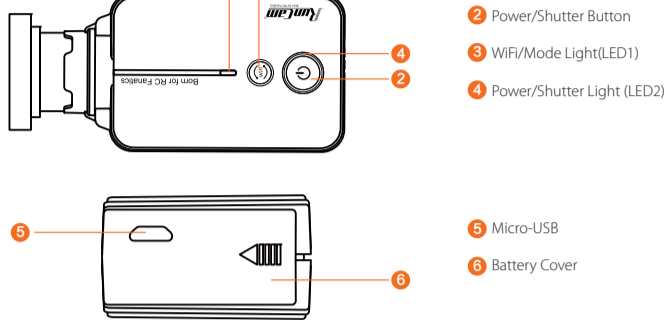

### Charging

Micro-USB supports DC 5-15V power supply. A DC 5V1~2A charger is recommended. The Power/Shutter Light(red) will turn on during charging and turn off when charging is complete. It takes about 2 hours to get fully charged.

### MicroSD Card

Capacity up to 64GB; Class 10/UHS-I/UHS-II/UHS-III is recommended.

### Basic Camera Operation

<b>Powering On/Off</b>	• Long press the Power/Shutter button
<b>WiFi On/Off</b>	• Short press the WiFi/Mode button If the Power/Shutter Light WiFi/Mode Light(LED1) blinks blue, it means it is ready to be connected and it will stop blinking and become always on after being connected. Default SSID: RUN_***** (* for letters or numbers) Default WiFi password: 1234567890
<b>Mode Switching</b>	• After powering on, long press the WiFi/Mode button to cycle among the three modes: Video/Photos/OSD settings.
<b>Video Mode</b>	Power/Shutter Light (LED2): <b>Blue</b> • Press the Power/Shutter button to start/stop recording.
<b>Photo Mode</b>	Power/Shutter Light (LED2): <b>Green</b> • Press the Power/Shutter button to capture photos.
<b>OSD Setup Mode</b>	WiFi/Mode Light(LED1): <b>Orange</b> • Press the Power/Shutter button to browse. • Press the WiFi/Mode button to select. • Long press the WiFi/Mode button to exit the current menu.
<b>Forced Shutdown</b>	• Simultaneously press the Power/Shutter button and WiFi/Mode button.
<b>Reset</b>	• In standby mode, press the WiFi/Mode button three times in rapid succession. The camera status light (orange) blinks twice. The camera completes its resetting and then automatically shuts down.

### Connection to computer

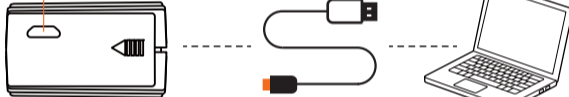

After turning on the RunCam2, connect it to the computer via USB cable, then it will be recognized as a removable disc.

**NOTICE:** If the camera can not be recognized by the computer after connecting, please make sure that a microSD card is well inserted. If the information on microSD card can not be read normally, please try with another micro USB cable or USB port on the computer.

### App

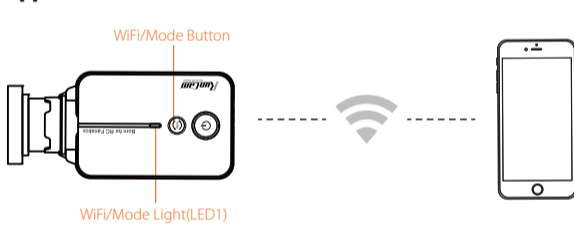

1. After powering on, press the WiFi/Mode button, the WiFi/Mode Light(LED1) (blue) blink when the WiFi is on and ready to connect.

2. In the wireless network settings of your smartphone, find the SSID connection of the RunCam2 and enter the password. After the successful connection, the WiFi/Mode Light (blue) will be constantly on.

**NOTICE:** If using under low light, you can increase exposure in camera menu via APP to improve the image quality and vice versa, decreasing it to avoid overexposure.

**Android and iOS APP:** Search 'RunCam App' on Google Play/App Store, or download on our website: <https://runcam.com/download/runcam2as>

### Firmware upgrade

Firmware Upgrade Status WiFi/Mode Light(LED1)(orange)  
Ensure that the battery is more than 50% before the upgrade.

#### Method 1 (recommended):

Connect your camera to your smartphone/tablet. If an update is available, the App provides instructions for installing it.

#### Method 2:

Manually copy the firmware file (RC2.BRN) onto the microSD card. Follow the instruction on <https://runcam.com/download/runcam2as>

To get the latest features and best performance from your RunCam2, make sure you are using the most current camera software. You can update your camera software with the RunCam App or at <https://runcam.com/download/runcam2as>

### Parameter

Best Recording Distance	16mm Lens (15~30 meters)
	25mm Lens (20~50 meters)
	35mm Lens (30~60 meters)
	50mm Lens (50~90 meters)
Video Resolution	1080p@60fps/1080p@30fps/720p@120fps/720p@60fps
Video File Format	MOV
Image Resolution	4MP
Communication Interface	Micro USB
microSD card supported	64G max
Dimension	83*38*21mm(35mm LENS)
Battery Capacity	850mAh
USB Power Input	DC 5-15V
Power Consumption	600mA @5V
Net Weight	65g (with battery)

### Technical Support

Please visit: <https://support.runcam.com>