

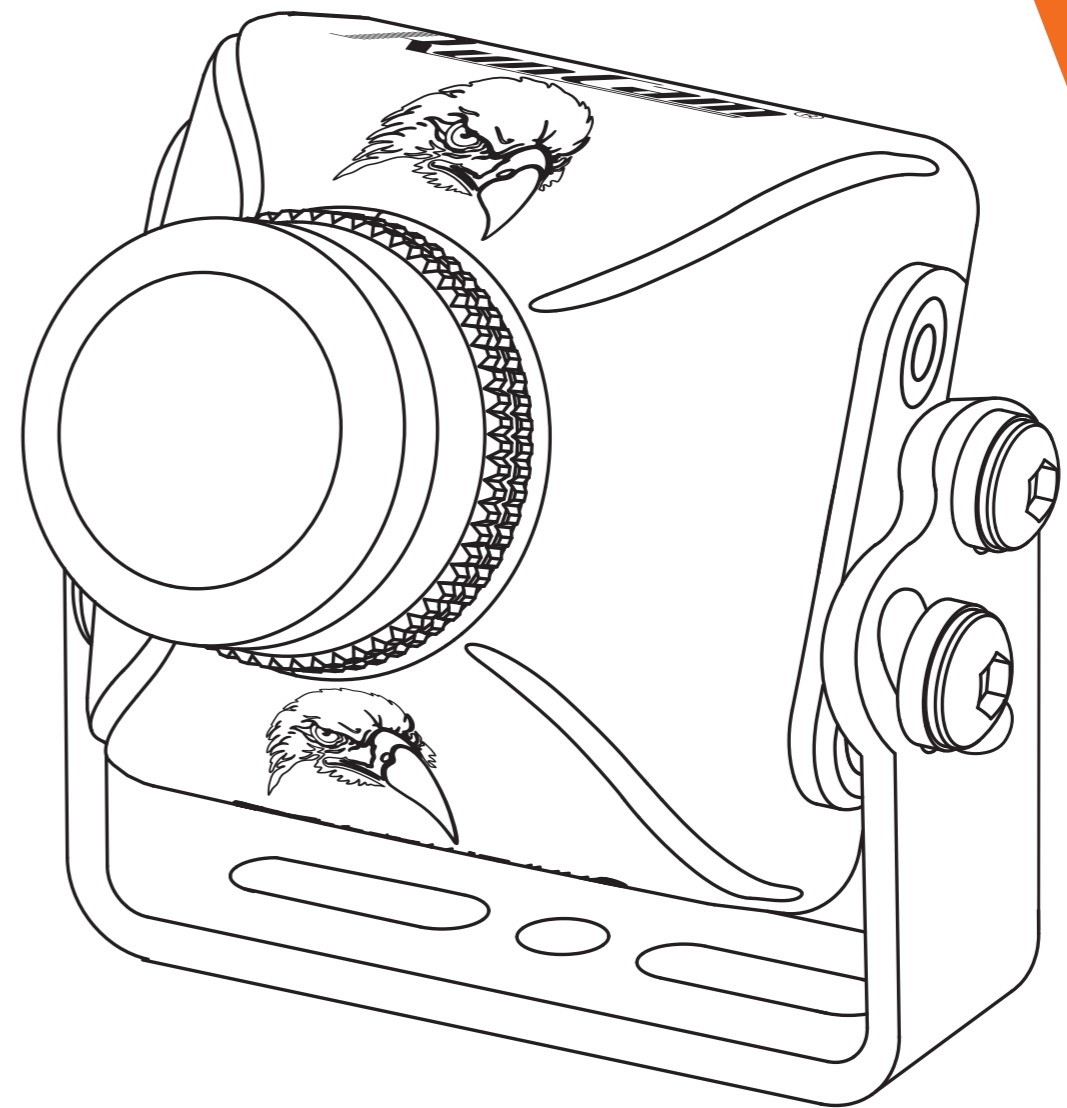

RUNCAM NIGHT EAGLE 2 USER MANUAL



Connection

* Unplug the 5D-OSD menu cable after OSD setting.

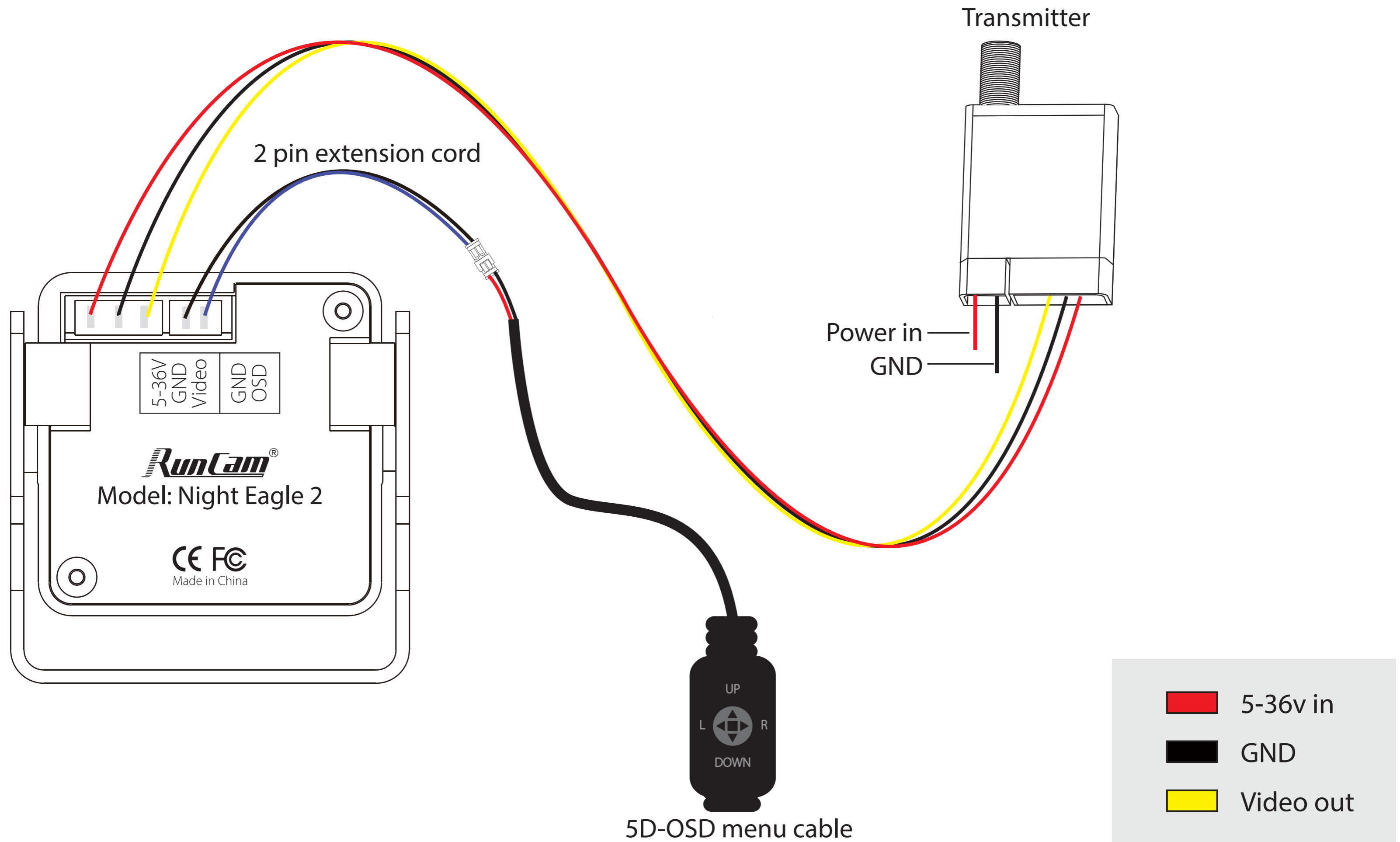

Dimensions & Installation

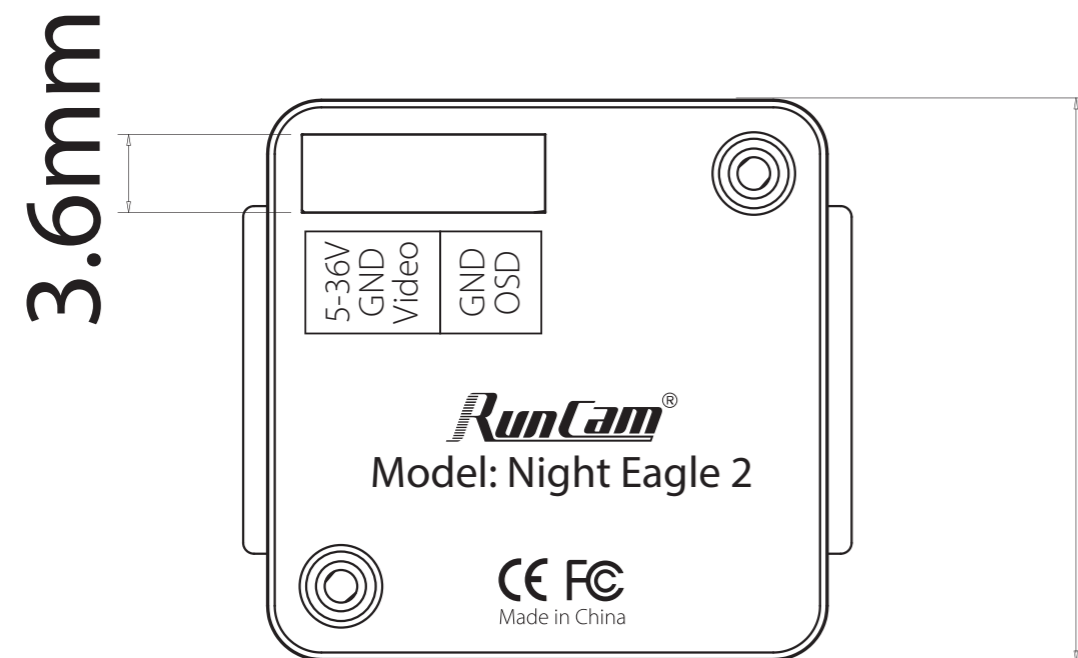
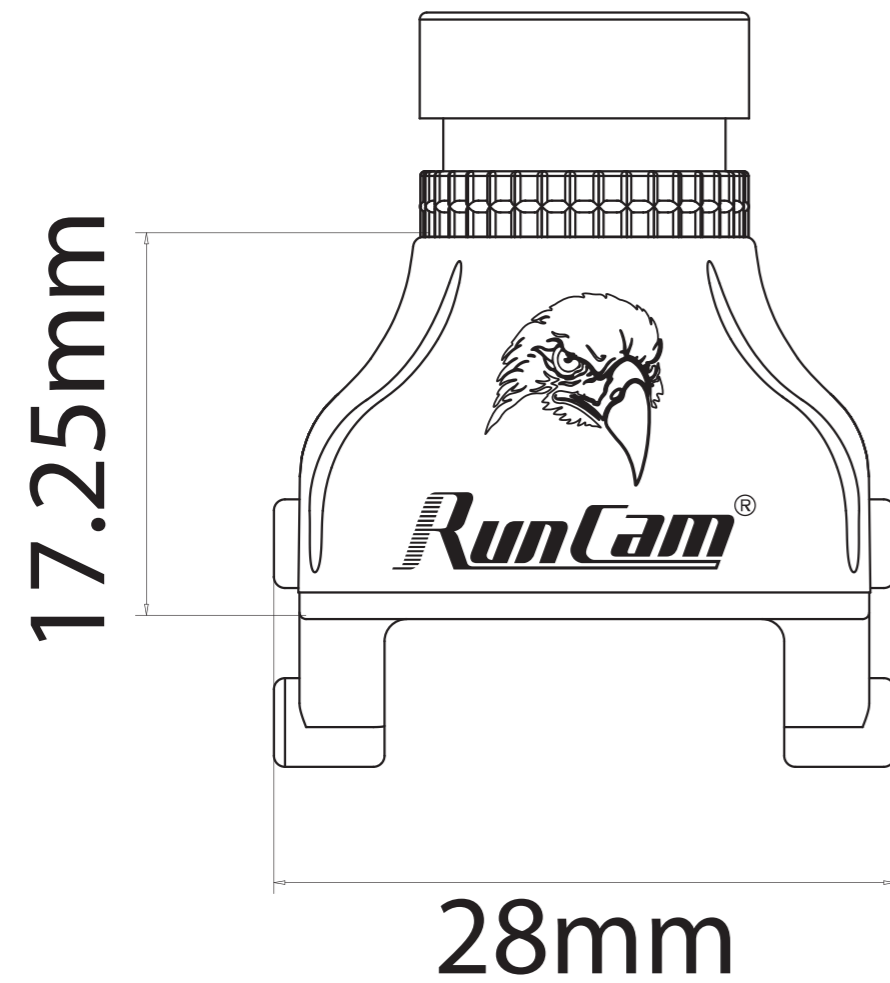

- 1 Nylon Gaskets
- 2 M2*4 Screws
- 3 M3*5 Screws
- 4 M3 Non-slip Nuts

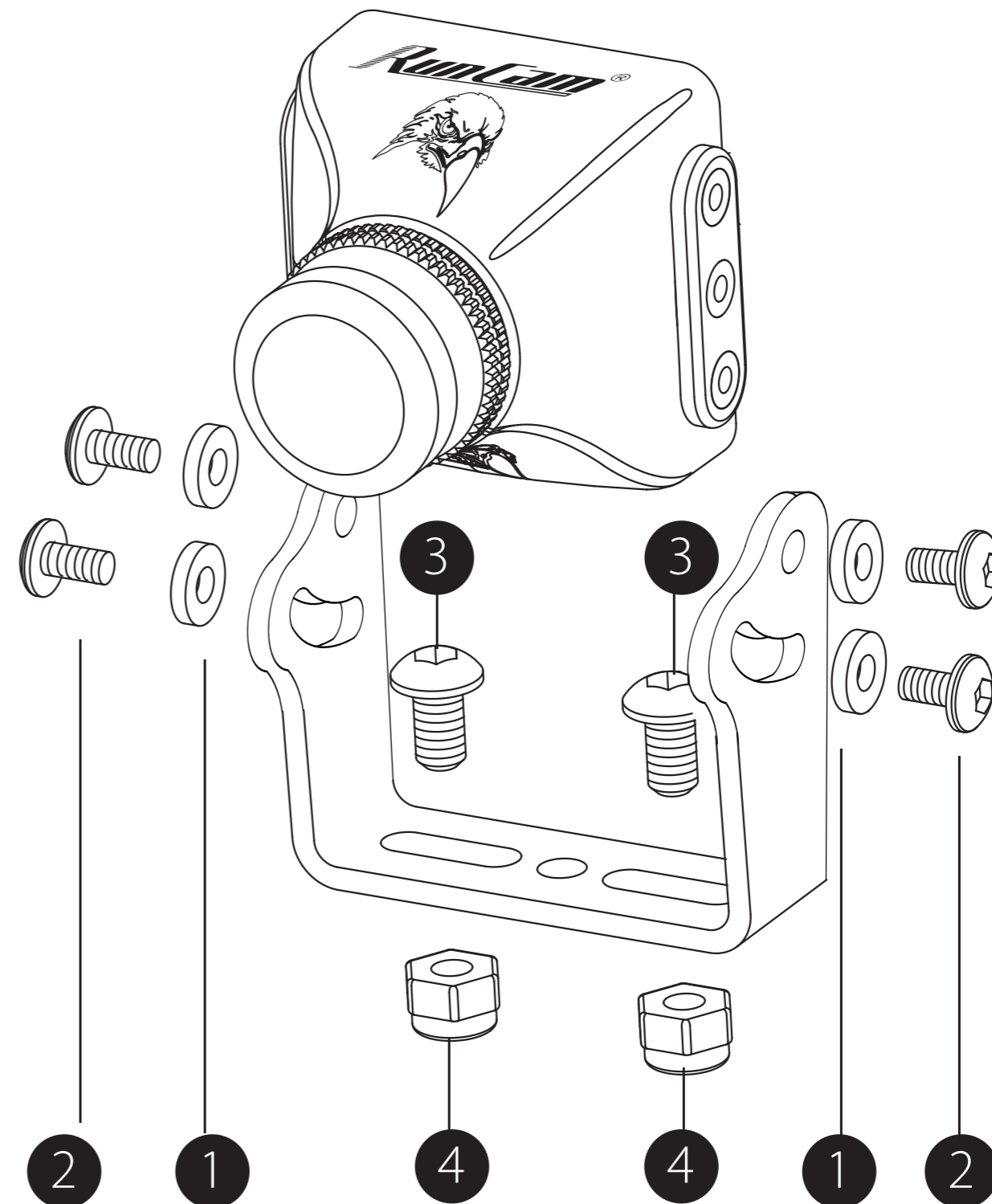

Camera Menu

MAINMENU	
IMAGE	←
VIDEO STANDARD	PAL-50HZ
LANGUAGE	ENGLISH
LOAD DEFAULT	
SOFT VERSION	*****
SAVE&EXIT	
EXIT	

- VIDEO STANDARD (PAL-50Hz/NTSC-60Hz)
- LANGUAGE (English/中文)

IMAGE	
MAX GAIN	9
WDR	ON
IMAGE ENHANCE	←
MIRROR	OFF
BRIGHTNESS	44
ZOOM IN	0
RETURN	←

- MAX GAIN (9 / 1-9)
- WDR (ON/OFF)
- MIRROR (OFF/ON)
- BRIGHTNESS (44 / 8-250)
- ZOOM IN (0 / 0-5)

Camera Menu

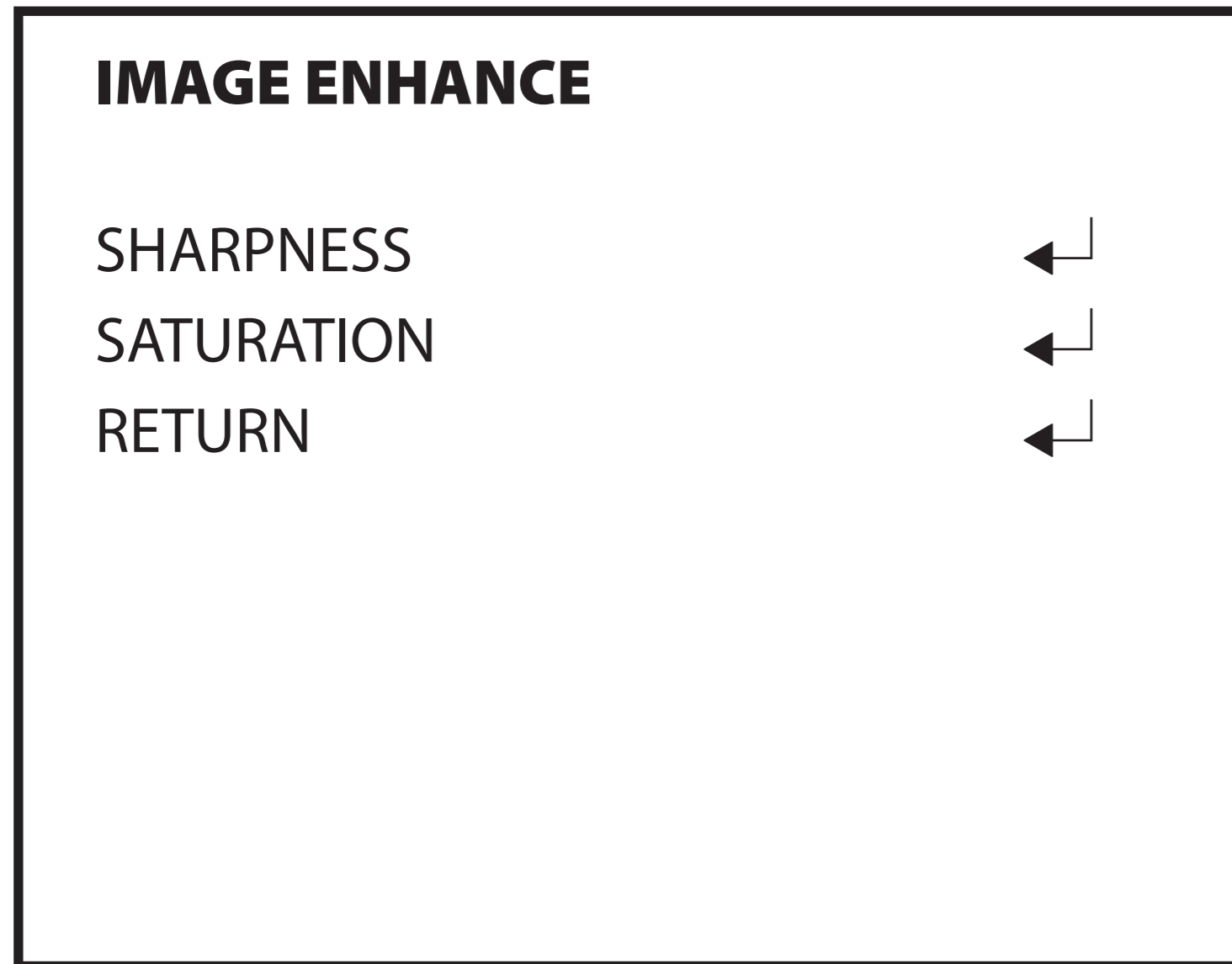

- SHARPNESS (AUTO/MANUAL: 0-15)
- SATURATION (AUTO/MANUAL: 0-15)

Model	RunCam Night Eagle 2
Image Sensor	1/1.8" CMOS Sensor
Horizontal Resolution	800TVL
Lens FOV	FOV 140 2.5mm
Screen Format	4:3
Signal System	NTSC/PAL Switchable on OSD menu
S/N Ratio	>50dB
Electronic Shutter Speed	Auto
Max Gain	1-9
Min. Illumination	0.00001Lux/F1.2
WDR	Global WDR
Day/Night	Only Black & White
Power	DC 5-36 V
Work Current	12V@90mA / 5V@200mA
Housing Material	Aluminum alloy
Net Weight	16g
Dimensions	28mm * 26mm * 28mm

www.runcam.com